

ADDENDUM | No. 1

PROJECT	Colton Glenn Avenue		
BID DATE	10:00 AM	CT	January 30, 2020
BID LOCATION	Colton City Hall 309 E 4 th Street Colton, SD 57018		
ISSUE DATE	January 21, 2020		
NOTICE	Failure to acknowledge all addenda in the BID may cause rejection of the BID. See Instructions to Bidders.		

SCOPE OF THIS ADDENDUM

The following becomes a part of the original project manual and drawings, taking precedence over the items that may conflict. The bidder shall note receipt and make acknowledgment of the Addendum on his/her bid form, incorporating its provision in his/her bid.

PROJECT MANUAL

The following additions, changes and clarifications have been made to the Project Manual.

Section – **CONDITIONS OF THE CONTRACT – SRF General Conditions with the Davis-Bacon and American Iron & Steel Provisions**

Delete:

2019 Davis-Bacon Wage Determination “General Decision”

Add:

2020 Davis-Bacon Wage Determination “General Decision” (5 pages attached to this document)

Section **EJCDC C-410 – Bid Form for Construction Contract**

Delete:

“Bid Form for Construction Contract” in its entirety (19 pages)

Add:

Updated “Bid Form for Construction Contract” (19 pages attached to this document)



DRAWINGS

The following additions, changes and clarifications have been made to the Drawings.

Drawing Sheet A-4

Remove:

Sheet A-4 "Estimate of Quantities Sheet" in its entirety

Add:

Sheet A-4 "Estimate of Quantities Sheet" signed January 21, 2020

Drawing Sheet I-3

Remove:

Sheet I-3 "Glenn Avenue Water & Sanitary Sewer – STA. 13+00 TO 18+00" in its entirety

Add:

Sheet I-3 "Glenn Avenue Water & Sanitary Sewer – STA. 13+00 to 18+00" signed January 21, 2020

NOTE

The Plan Holders List and Addendums are available on our website at <http://www.bannerassociates.com> by clicking on **View Bid Information / Project Name / Project Information** link.

Project Manual and Drawing inquiries regarding the work should be directed to:

CONTACT PERSON(S)

Banner Associates, Inc.

Tel 1-605-692-6342 | Toll Free 1-855-323-6342 | Fax 1-605-692-5714

Waylon Blasius

Project Engineer

waylonb@bannerassociates.com

ATTACHMENTS

1. 2020 Davis-Bacon Wage Determination
2. Section C-410 "Bid Form for Construction Contract"
3. Drawing Sheet A-4
4. Drawing Sheet I-3



Waylon Blasius, PE #13392

"General Decision Number: SD20200001 01/03/2020

Superseded General Decision Number: SD20190001

State: South Dakota

Construction Types: Heavy and Highway

Counties: South Dakota Statewide.

HEAVY AND HIGHWAY CONSTRUCTION PROJECTS

Note: Under Executive Order (EO) 13658, an hourly minimum wage of \$10.80 for calendar year 2020 applies to all contracts subject to the Davis-Bacon Act for which the contract is awarded (and any solicitation was issued) on or after January 1, 2015. If this contract is covered by the EO, the contractor must pay all workers in any classification listed on this wage determination at least \$10.80 per hour (or the applicable wage rate listed on this wage determination, if it is higher) for all hours spent performing on the contract in calendar year 2020. If this contract is covered by the EO and a classification considered necessary for performance of work on the contract does not appear on this wage determination, the contractor must pay workers in that classification at least the wage rate determined through the conformance process set forth in 29 CFR 5.5(a)(1)(ii) (or the EO minimum wage rate, if it is higher than the conformed wage rate). The EO minimum wage rate will be adjusted annually. Please note that this EO applies to the above-mentioned types of contracts entered into by the federal government that are subject to the Davis-Bacon Act itself, but it does not apply to contracts subject only to the Davis-Bacon Related Acts, including those set forth at 29 CFR 5.1(a)(2)-(60). Additional information on contractor requirements and worker protections under the EO is available at www.dol.gov/whd/govcontracts.

Modification Number	Publication Date
0	01/03/2020

* SUSD2018-001 03/20/2018

	Rates	Fringes
CARPENTER.....	\$ 27.96	0.00
CONCRETE FINISHER.....	\$ 21.41	0.00
ELECTRICIAN.....	\$ 26.42	3.85
LABORER		
Group 1.....	\$ 18.86	0.00

Group 2.....	\$ 17.51	0.00
Group 3.....	\$ 18.95	0.00
Group 5.....	\$ 27.96	0.00
Group 6.....	\$ 21.41	0.00

LABORER CLASSIFICATIONS:

GROUP 1: Air Tool Operator; Common Laborer; Landscape Worker, Flagger, Pilot Car Driver; Trucks under 26,000 GVW; Blue-top Checker, Materials Checker.

GROUP 2: Mechanic Tender; Pipe Layer (except culvert); Form Builder Tender; Special Surface Finish Applicator; Striping.

GROUP 3: Asphalt Plant Tender; Pile Driver Leadsman; Form Setter, Oiler/Greaser.

GROUP 5: Form Builder

GROUP 6: Grade Checker

PAINTER.....	\$ 21.41	0.00
--------------	----------	------

POWER EQUIPMENT OPERATOR:

Group 1.....	\$ 20.62	0.00
Group 2.....	\$ 20.66	0.00
Group 3.....	\$ 22.02	0.00
Group 4.....	\$ 23.79	0.00
Group 5.....	\$ 24.77	0.00

POWER EQUIPMENT OPERATORS CLASSIFICATIONS

GROUP 1: Concrete Paving Cure Machine; Concrete Paving Joint Sealer; Conveyor; Tractor (farm type with attachments); Self-Propelled Broom; Concrete Routing Machine; Paver Feeder; Pugmill; Skid Steer.

GROUP 2: Bull Dozer 80 HP or less; Front End Loader 1.25 CY or less; Self-Propelled Roller (except Hot Mix); Sheepsfoot/50 Ton Pneumatic Roller; Pneumatic Tire Tractor or Crawler (includes Water Wagon and Power Spray Units); Wagon Drill; Air Trac; Truck Type Auger; Concrete Paving Saw.

GROUP 3: Asphalt Distributor; Bull Dozer over 80 HP; Concrete Paving Finishing Machine; Backhoes/Excavators 20 tons or less; Crusher (may include internal screening plant); Front End Loader over 1.25 CY; Rough Motor Grader; Self-Propelled Hot Mix Roller; Push Tractor; Euclid or Dumpster; Material Spreader; Rumble Strip Machine.

GROUP 4: Asphalt Paving Machine Screed; Asphalt Paving Machine; Cranes/Derricks/Draglines/Pile Drivers/Shovels 30 to 50 tons; Backhoes/Excavators 21 to 40 tons; Maintenance Mechanic; Scrapers; Concrete Pump Truck.

GROUP 5: Asphalt Plant; Concrete Batch Plant; Backhoes/Excavators over 40 tons; Cranes/Derricks/Draglines/Pile Drivers/Shovels over 50 tons; Heavy Duty Mechanic; Finish Motor Grader; Automatic Fine Grader; Milling Machine; Bridge Welder.

TRUCK DRIVER

Group 1.....	\$ 21.46	0.00
Group 2.....	\$ 21.66	4.22

TRUCK DRIVERS CLASSIFICATIONS

GROUP 1: Tandem Truck without trailer or pup; Single Axle
Truck over 26,000 GVW with trailer.

GROUP 2: Semi-Tractor and Trailer; Tandem Truck with Pup.

WELDERS - Receive rate prescribed for craft performing
operation to which welding is incidental.

=====

Note: Executive Order (EO) 13706, Establishing Paid Sick Leave for Federal Contractors applies to all contracts subject to the Davis-Bacon Act for which the contract is awarded (and any solicitation was issued) on or after January 1, 2017. If this contract is covered by the EO, the contractor must provide employees with 1 hour of paid sick leave for every 30 hours they work, up to 56 hours of paid sick leave each year. Employees must be permitted to use paid sick leave for their own illness, injury or other health-related needs, including preventive care; to assist a family member (or person who is like family to the employee) who is ill, injured, or has other health-related needs, including preventive care; or for reasons resulting from, or to assist a family member (or person who is like family to the employee) who is a victim of, domestic violence, sexual assault, or stalking. Additional information on contractor requirements and worker protections under the EO is available at www.dol.gov/whd/govcontracts.

Unlisted classifications needed for work not included within the scope of the classifications listed may be added after award only as provided in the labor standards contract clauses (29CFR 5.5 (a) (1) (ii)).

The body of each wage determination lists the classification and wage rates that have been found to be prevailing for the cited type(s) of construction in the area covered by the wage determination. The classifications are listed in alphabetical order of ""identifiers"" that indicate whether the particular rate is a union rate (current union negotiated rate for local), a survey rate (weighted average rate) or a union average rate (weighted union average rate).

Union Rate Identifiers

A four letter classification abbreviation identifier enclosed in dotted lines beginning with characters other than ""SU"" or ""UAVG"" denotes that the union classification and rate were

prevailing for that classification in the survey. Example: PLUM0198-005 07/01/2014. PLUM is an abbreviation identifier of the union which prevailed in the survey for this classification, which in this example would be Plumbers. 0198 indicates the local union number or district council number where applicable, i.e., Plumbers Local 0198. The next number, 005 in the example, is an internal number used in processing the wage determination. 07/01/2014 is the effective date of the most current negotiated rate, which in this example is July 1, 2014.

Union prevailing wage rates are updated to reflect all rate changes in the collective bargaining agreement (CBA) governing this classification and rate.

Survey Rate Identifiers

Classifications listed under the ""SU"" identifier indicate that no one rate prevailed for this classification in the survey and the published rate is derived by computing a weighted average rate based on all the rates reported in the survey for that classification. As this weighted average rate includes all rates reported in the survey, it may include both union and non-union rates. Example: SULA2012-007 5/13/2014. SU indicates the rates are survey rates based on a weighted average calculation of rates and are not majority rates. LA indicates the State of Louisiana. 2012 is the year of survey on which these classifications and rates are based. The next number, 007 in the example, is an internal number used in producing the wage determination. 5/13/2014 indicates the survey completion date for the classifications and rates under that identifier.

Survey wage rates are not updated and remain in effect until a new survey is conducted.

Union Average Rate Identifiers

Classification(s) listed under the UAVG identifier indicate that no single majority rate prevailed for those classifications; however, 100% of the data reported for the classifications was union data. EXAMPLE: UAVG-OH-0010 08/29/2014. UAVG indicates that the rate is a weighted union average rate. OH indicates the state. The next number, 0010 in the example, is an internal number used in producing the wage determination. 08/29/2014 indicates the survey completion date for the classifications and rates under that identifier.

A UAVG rate will be updated once a year, usually in January of each year, to reflect a weighted average of the current negotiated/CBA rate of the union locals from which the rate is based.

1.) Has there been an initial decision in the matter? This can be:

- * an existing published wage determination
- * a survey underlying a wage determination
- * a Wage and Hour Division letter setting forth a position on a wage determination matter
- * a conformance (additional classification and rate) ruling

On survey related matters, initial contact, including requests for summaries of surveys, should be with the Wage and Hour Regional Office for the area in which the survey was conducted because those Regional Offices have responsibility for the Davis-Bacon survey program. If the response from this initial contact is not satisfactory, then the process described in 2.) and 3.) should be followed.

With regard to any other matter not yet ripe for the formal process described here, initial contact should be with the Branch of Construction Wage Determinations. Write to:

Branch of Construction Wage Determinations
Wage and Hour Division
U.S. Department of Labor
200 Constitution Avenue, N.W.
Washington, DC 20210

2.) If the answer to the question in 1.) is yes, then an interested party (those affected by the action) can request review and reconsideration from the Wage and Hour Administrator (See 29 CFR Part 1.8 and 29 CFR Part 7). Write to:

Wage and Hour Administrator
U.S. Department of Labor
200 Constitution Avenue, N.W.
Washington, DC 20210

The request should be accompanied by a full statement of the interested party's position and by any information (wage payment data, project description, area practice material, etc.) that the requestor considers relevant to the issue.

3.) If the decision of the Administrator is not favorable, an interested party may appeal directly to the Administrative Review Board (formerly the Wage Appeals Board). Write to:

Administrative Review Board
U.S. Department of Labor
200 Constitution Avenue, N.W.
Washington, DC 20210

4.) All decisions by the Administrative Review Board are final.

=====

END OF GENERAL DECISION

..

BID FORM FOR CONSTRUCTION CONTRACT

The terms used in this Bid with initial capital letters have the meanings stated in the Instructions to Bidders, the General Conditions, and the Supplementary Conditions.

ARTICLE 1—OWNER AND BIDDER

1.01 This Bid is submitted to:

City of Colton
309 E 4th Street
Colton, SD 57018

1.02 The undersigned Bidder proposes and agrees, if this Bid is accepted, to enter into an Agreement with Owner in the form included in the Bidding Documents to perform all Work as specified or indicated in the Bidding Documents for the prices and within the times indicated in this Bid and in accordance with the other terms and conditions of the Bidding Documents.

ARTICLE 2—ATTACHMENTS TO THIS BID

2.01 The following documents are submitted with and made a condition of this Bid:

- A. Required Bid security;
- B. List of Proposed Subcontractors;
- C. List of Proposed Suppliers;
- D. Evidence of authority to do business in the state of the Project; or a written covenant to obtain such authority within the time for acceptance of Bids;
- E. Contractor's license number as evidence of Bidder's State Contractor's License or a covenant by Bidder to obtain said license within the time for acceptance of Bids;
- F. Required Bidder Qualification Statement with supporting data; and
- G. DBE Subcontractor Solicitation Information
- H. Certification Regarding Debarment, Suspension, and Other Responsibility Matters
- I. American Iron and Steel Certification

2.02 The following forms must be submitted by the apparent low-bidder within ten calendar days of the bid opening:

- A. Form 6100-3 – DBE Subcontractor Performance Form
- B. Form 6100-4 – DBE Subcontractor Utilization Form
- C. EEO-7 – Notification of Subcontractor Awarded > \$10,000

COLTON GLENN AVENUE STREET/ UTILITY IMPROVEMENTS
COLTON, SOUTH DAKOTA
BID FORM

ARTICLE 3—BASIS OF BID—UNIT PRICES

3.01 Unit Price Bids

A. Bidder will perform the following Work at the indicated unit prices:

UNIT PRICE BASE BID

NOTE: Bidder shall Bid all Items of the Schedule

ITEM NO.	SPEC SECTION	DESCRIPTION OF WORK AND MATERIALS	QTY	UNIT	UNIT PRICE	TOTAL COST
1	SC-6.03	Railroad Protective Liability Insurance	1	Lump Sum	\$	\$
2	01 0000-5.4	Flagging	4	Hour	\$	\$
3	01 0000-5.4	Traffic Control	453	SF	\$	\$
4	01 0000-5.4	Type 3 Barricade - 6 Ft. Double-Sided	4	Each	\$	\$
5	01 0000-5.4	Type 3 Barricade - 8 Ft. Single-Sided	15	Each	\$	\$
6	01 0000-5.4	Traffic Control, Miscellaneous	1	Lump Sum	\$	\$
7	01 0000-5.6	Salvage & Reinstall Mailbox	1	Each	\$	\$
8	01 0000-5.6	Temporary Mailbox	18	Each	\$	\$
9	01 7113-2.1	Mobilization	1	Lump Sum	\$	\$

COLTON GLENN AVENUE STREET/ UTILITY IMPROVEMENTS
COLTON, SOUTH DAKOTA
BID FORM

ITEM NO.	SPEC SECTION	DESCRIPTION OF WORK AND MATERIALS	QTY	UNIT	UNIT PRICE	TOTAL COST
10	31 2300-4.2	Remove Dumping Station	1	Lump Sum	\$	\$
11	31 2300-4.2	Remove Tree	13	Each	\$	\$
12	31 2300-4.2	Remove Existing Bituminous Surfacing	7,345	SY	\$	\$
13	31 2300-4.2	Remove Existing Gravel Surfacing	384	SY	\$	\$
14	31 2300-4.2	Remove Existing Curb and Gutter	1,007	LF	\$	\$
15	31 2300-4.2	Remove Existing Concrete Surfacing	106	SY	\$	\$
16	31 2300-4.2	Remove Storm Sewer Pipe	48	LF	\$	\$
17	31 2300-4.2	Remove Gate Valve & Box	5	Each	\$	\$
18	31 2300-4.2	Remove Gate Valve Box	2	Each	\$	\$
19	31 2300-4.2	Remove Fire Hydrant	4	Each	\$	\$
20	31 2300-4.2	Remove Sanitary Sewer Manhole	9	Each	\$	\$
21	31 2300-4.3	Compaction - Moisture/Density Tests	59	Each	\$	\$

COLTON GLENN AVENUE STREET/ UTILITY IMPROVEMENTS
COLTON, SOUTH DAKOTA
BID FORM

ITEM NO.	SPEC SECTION	DESCRIPTION OF WORK AND MATERIALS	QTY	UNIT	UNIT PRICE	TOTAL COST
22	31 2300-4.4	Sanitary Sewer Bedding Material	1,230	Ton	\$	\$
23	31 2300-4.4	Watermain Bedding Material	850	Ton	\$	\$
24	31 2300-4.5	Pipe Foundation Material	100	Ton	\$	\$
25	31 2300-4.6	Imported Trench Backfill Material	14,406	Ton	\$	\$
26	31 2300-4.8	Exploratory Excavation	10	Hour	\$	\$
27	31 2400-4.3	Unclassified Excavation	3,550	CY	\$	\$
28	31 2400-4.4	Scarify and Recompact	215	CY	\$	\$
29	31 2400-4.5	Digout Excavation	50	CY	\$	\$
30	31 2400-4.7	Subbase Foundation Aggregate	100	Ton	\$	\$
31	31 2400-4.8	Imported Topsoil	500	CY	\$	\$
32	31 2400-4.9	Strip, Stockpile, and Reinstall Topsoil	525	CY	\$	\$
33	31 2400-4.10	Cement Treated Subgrade	60,600	SF	\$	\$

COLTON GLENN AVENUE STREET/ UTILITY IMPROVEMENTS
COLTON, SOUTH DAKOTA
BID FORM

ITEM NO.	SPEC SECTION	DESCRIPTION OF WORK AND MATERIALS	QTY	UNIT	UNIT PRICE	TOTAL COST
34	31 2400-4.11	Portland Cement	167	Ton	\$	\$
35	31 2500-4.1	Erosion Control Blanket	308	SY	\$	\$
36	31 2500-4.2	Silt Fence	215	LF	\$	\$
37	31 2500-4.3	Inlet Sediment Control Device	1	Each	\$	\$
38	31 2500-4.4	Temporary Vehicle Construction Entrance	7	Each	\$	\$
39	31 2500-4.5	Concrete Washout Area	1	Each	\$	\$
40	32 1123-4.1	Base Course	3,911	Ton	\$	\$
41	32 1123-4.2	Geotextile Fabric	1,429	SY	\$	\$
42	32 1216-4.1	Asphalt Concrete, Class G, Type 2	830	Ton	\$	\$
43	32 1216-4.1	Asphalt Concrete, Class G, Type 1	845	Ton	\$	\$
44	32 1216-4.3	Asphalt Concrete Sampling and Testing	4	Each	\$	\$
45	32 1613-4.1	Concrete Curb and Gutter	913	LF	\$	\$

COLTON GLENN AVENUE STREET/ UTILITY IMPROVEMENTS
COLTON, SOUTH DAKOTA
BID FORM

ITEM NO.	SPEC SECTION	DESCRIPTION OF WORK AND MATERIALS	QTY	UNIT	UNIT PRICE	TOTAL COST
46	32 1613-4.2	Concrete Valley Gutter	375	SF	\$	\$
47	32 1613-4.3	Concrete Fillet Section	555	SF	\$	\$
48	32 1613-4.4	6" Concrete Approach/Driveway Pavement	862	SF	\$	\$
49	32 1613-4.5	Concrete Sampling and Testing	2	Each	\$	\$
50	32 9200-4.1	Seeding	1.2	Acre	\$	\$
51	33 1000-4.2	8" Dia. PVC Watermain	1,646	LF	\$	\$
52	33 1000-4.2	6" Dia. PVC Watermain	151	LF	\$	\$
53	33 1000-4.2	4" Dia. PVC Watermain	4	LF	\$	\$
54	33 1000-4.2	6" Dia. RJ PVC Watermain	80	LF	\$	\$
55	33 1000-4.3	8" D.I. M.J. 45 Deg. Bend w/ Joint Restraints	2	Each	\$	\$
56	33 1000-4.3	6" D.I. M.J. 45 Deg. Bend w/ Joint Restraints	2	Each	\$	\$
57	33 1000-4.3	8" D.I. M.J. 11.25 Deg. Bend w/ Joint Restraints	1	Each	\$	\$

COLTON GLENN AVENUE STREET/ UTILITY IMPROVEMENTS
COLTON, SOUTH DAKOTA
BID FORM

ITEM NO.	SPEC SECTION	DESCRIPTION OF WORK AND MATERIALS	QTY	UNIT	UNIT PRICE	TOTAL COST
58	33 1000-4.3	8" x 6" D.I. M.J. Reducer w/ Joint Restraints	2	Each	\$	\$
59	33 1000-4.3	8" x 4" D.I. M.J. Reducer w/ Joint Restraints	1	Each	\$	\$
60	33 1000-4.3	8" Dia. D.I. M.J. Long Body Sleeve w/ Joint Restraints	1	Each	\$	\$
61	33 1000-4.3	6" Dia. D.I. M.J. Long Body Sleeve w/ Joint Restraints	5	Each	\$	\$
62	33 1000-4.3	4" Dia. D.I. M.J. Long Body Sleeve w/ Joint Restraints	1	Each	\$	\$
63	33 1000-4.3	8" x 8" D.I. M.J. Tee w/ Joint Restraints	2	Each	\$	\$
64	33 1000-4.3	8" x 6" D.I. M.J. Tee w/ Joint Restraints	6	Each	\$	\$
65	33 1000-4.4	8" Dia. D.I. M.J. Gate Valve & Box w/ Joint Restraints	8	Each	\$	\$
66	33 1000-4.4	6" Dia. D.I. M.J. Gate Valve & Box w/ Joint Restraints	6	Each	\$	\$
67	33 1000-4.5	Fire Hydrant w/ Joint Restraints	3	Each	\$	\$
68	33 1000-4.6	Concrete for Thrust Blocks	4	CY	\$	\$
69	33 1000-4.7	2" Dia. PE Water Service Pipe	42	LF	\$	\$

COLTON GLENN AVENUE STREET/ UTILITY IMPROVEMENTS
COLTON, SOUTH DAKOTA
BID FORM

ITEM NO.	SPEC SECTION	DESCRIPTION OF WORK AND MATERIALS	QTY	UNIT	UNIT PRICE	TOTAL COST
70	33 1000-4.7	1" Dia. PE Water Service Pipe	580	LF	\$	\$
71	33 1000-4.8	2" Corporation Stop and Service Saddle	1	Each	\$	\$
72	33 1000-4.8	1" Corporation Stop and Service Saddle	18	Each	\$	\$
73	33 1000-4.9	2" Curb Stop and Box	1	Each	\$	\$
74	33 1000-4.9	1" Curb Stop and Box	18	Each	\$	\$
75	33 1000-4.10	24" Steel Encasement Pipe - Railroad Crossing	60	LF	\$	\$
76	33 1000-4.10	20" Steel Encasement Pipe - Railroad Crossing	45	LF	\$	\$
77	33 1000-4.11	16" PVC Encasement Pipe	20	LF	\$	\$
78	33 1000-4.12	Temporary Water Service	1	Lump Sum	\$	\$
79	33 1000-4.13	Tracer Wire	1,997	LF	\$	\$
80	33 1000-4.14	Rigid Insulation	48	LF	\$	\$
81	33 1000-4.15	Temporary Fire Hydrant	1	Each	\$	\$

COLTON GLENN AVENUE STREET/ UTILITY IMPROVEMENTS
COLTON, SOUTH DAKOTA
BID FORM

ITEM NO.	SPEC SECTION	DESCRIPTION OF WORK AND MATERIALS	QTY	UNIT	UNIT PRICE	TOTAL COST
82	33 3000-4.2	12" Dia. PVC Gravity Sewer Pipe	371	LF	\$	\$
83	33 3000-4.2	10" Dia. PVC Gravity Sewer Pipe	278	LF	\$	\$
84	33 3000-4.2	8" Dia. PVC Gravity Sewer Pipe	1,703	LF	\$	\$
85	33 3000-4.2	10" Dia. R.J. PVC Gravity Sewer Pipe	80	LF	\$	\$
86	33 3000-4.2	4" Dia. PVC Gravity Sewer Pipe	663	LF	\$	\$
87	33 3000-4.3	8" x 4" Sanitary Sewer Service Connection	20	Each	\$	\$
88	33 3000-4.3	10" x 4" Sanitary Sewer Service Connection	4	Each	\$	\$
89	33 3000-4.3	12" x 4" Sanitary Sewer Service Connection	2	Each	\$	\$
90	33 3000-4.4	48" Dia. Sanitary Sewer Manhole	10	Each	\$	\$
91	33 3000-4.5	Additional Vertical Manhole Feet	27	VF	\$	\$
92	33 4100-4.2	48" Arch RCP Storm Sewer	48	LF	\$	\$
93	33 4100-4.4	6' x 3' Sioux Falls Drop Inlet	1	Each	\$	\$

COLTON GLENN AVENUE STREET/ UTILITY IMPROVEMENTS
COLTON, SOUTH DAKOTA
BID FORM

TOTAL FOR UNIT PRICE BASE BID

\$

COLTON GLENN AVENUE STREET/ UTILITY IMPROVEMENTS
COLTON, SOUTH DAKOTA
BID FORM

UNIT PRICE ALTERNATE BID A

NOTE: Bidder shall Bid all Items of the Schedule

ITEM NO.	SPEC SECTION	DESCRIPTION OF WORK AND MATERIALS	QTY	UNIT	UNIT PRICE	TOTAL COST
A-1	01 7113-2.1	Mobilization	1	Lump Sum	\$	\$
A-2	01 0000-5.6	Salvage & Reinstall Mailbox	2	Each	\$	\$
A-3	01 0000-5.6	Temporary Mailbox	2	Each	\$	\$
A-4	31 2300-4.2	Remove Existing Bituminous Surfacing	1,117	SY	\$	\$
A-5	31 2300-4.2	Remove Existing Curb and Gutter	240	LF	\$	\$
A-6	31 2300-4.2	Remove Existing Concrete Surfacing	43	SY	\$	\$
A-7	31 2300-4.2	Remove Gate Valve & Box	1	Each	\$	\$
A-8	31 2300-4.2	Remove Fire Hydrant	1	Each	\$	\$
A-9	31 2300-4.3	Compaction - Moisture/Density Tests	6	Each	\$	\$
A-10	31 2300-4.4	Sanitary Sewer Bedding Material	150	Ton	\$	\$
A-11	31 2300-4.4	Watermain Bedding Material	130	Ton	\$	\$

EJCDC® C-410, Bid Form for Construction Contract.

Copyright© 2018 National Society of Professional Engineers, American Council of Engineering Companies,
and American Society of Civil Engineers. All rights reserved.

COLTON GLENN AVENUE STREET/ UTILITY IMPROVEMENTS
COLTON, SOUTH DAKOTA
BID FORM

ITEM NO.	SPEC SECTION	DESCRIPTION OF WORK AND MATERIALS	QTY	UNIT	UNIT PRICE	TOTAL COST
A-12	31 2300-4.6	Imported Trench Backfill Material	2,244	Ton	\$	\$
A-13	31 2400-4.3	Unclassified Excavation	250	CY	\$	\$
A-14	31 2400-4.8	Imported Topsoil	40	CY	\$	\$
A-15	31 2400-4.10	Cement Treated Subgrade	10,250	SF	\$	\$
A-16	31 2400-4.11	Portland Cement	30	Ton	\$	\$
A-17	31 2500-4.4	Temporary Vehicle Construction Entrance	1	Each	\$	\$
A-18	32 1123-4.1	Base Course	537	Ton	\$	\$
A-19	32 1123-4.2	Geotextile Fabric	104	SY	\$	\$
A-20	32 1216-4.1	Asphalt Concrete, Class G, Type 2	134	Ton	\$	\$
A-21	32 1216-4.1	Asphalt Concrete, Class G, Type 1	134	Ton	\$	\$
A-22	32 1613-4.1	Concrete Curb and Gutter	204	LF	\$	\$
A-23	32 1613-4.2	Concrete Valley Gutter	218	SF	\$	\$

COLTON GLENN AVENUE STREET/ UTILITY IMPROVEMENTS
COLTON, SOUTH DAKOTA
BID FORM

ITEM NO.	SPEC SECTION	DESCRIPTION OF WORK AND MATERIALS	QTY	UNIT	UNIT PRICE	TOTAL COST
A-24	32 1613-4.3	Concrete Fillet Section	141	SF	\$	\$
A-25	32 1613-4.4	6" Concrete Approach/Driveway Pavement	271	SF	\$	\$
A-26	32 9200-4.1	Seeding	0.1	Acre	\$	\$
A-27	33 1000-4.2	6" Dia. PVC Watermain	336	LF	\$	\$
A-28	33 1000-4.3	6" D.I. M.J. 45 Deg. Bend w/ Joint Restraints	2	Each	\$	\$
A-29	33 1000-4.3	6" Dia. D.I. M.J. Long Body Sleeve w/ Joint Restraints	1	Each	\$	\$
A-30	33 1000-4.3	6" x 6" D.I. M.J. Tee w/ Joint Restraints	1	Each	\$	\$
A-31	33 1000-4.4	6" Dia. D.I. M.J. Gate Valve & Box w/ Joint Restraints	2	Each	\$	\$
A-32	33 1000-4.5	Fire Hydrant w/ Joint Restraints	1	Each	\$	\$
A-33	33 1000-4.6	Concrete for Thrust Blocks	1	CY	\$	\$
A-34	33 1000-4.7	1" Dia. PE Water Service Pipe	95	LF	\$	\$
A-35	33 1000-4.8	1" Corporation Stop and Service Saddle	4	Each	\$	\$

COLTON GLENN AVENUE STREET/ UTILITY IMPROVEMENTS
COLTON, SOUTH DAKOTA
BID FORM

ITEM NO.	SPEC SECTION	DESCRIPTION OF WORK AND MATERIALS	QTY	UNIT	UNIT PRICE	TOTAL COST
A-36	33 1000-4.9	1" Curb Stop and Box	4	Each	\$	\$
A-37	33 1000-4.13	Tracer Wire	358	LF	\$	\$
A-38	33 3000-4.2	8" Dia. PVC Gravity Sewer Pipe	316	LF	\$	\$
A-39	33 3000-4.2	4" Dia. PVC Gravity Sewer Pipe	110	LF	\$	\$
A-40	33 3000-4.3	8" x 4" Sanitary Sewer Service Connection	4	Each	\$	\$
TOTAL FOR UNIT PRICE ALTERNATE BID A			\$			

UNIT PRICE ALTERNATE BID B

NOTE: Bidder shall Bid all Items of the Schedule

ITEM NO.	SPEC SECTION	DESCRIPTION OF WORK AND MATERIALS	QTY	UNIT	UNIT PRICE	TOTAL COST
B-1	31 2300-4.2	Remove Storm Sewer Pipe	175	LF	\$	\$
B-2	33 4100-4.2	48" Arch RCP Storm Sewer	175	LF	\$	\$
B-3	33 4100-4.3	48" Arch RCP Flared End Section	1	Each	\$	\$
TOTAL FOR UNIT PRICE ALTERNATE BID B			\$			
TOTAL FOR UNIT PRICE BASE BID						
+ TOTAL FOR UNIT PRICE ALTERNATE BID A			\$			
+ TOTAL FOR UNIT PRICE ALTERNATE BID B						

B. Bidder acknowledges that:

1. each Bid Unit Price includes an amount considered by Bidder to be adequate to cover Contractor's overhead and profit for each separately identified item, and
2. estimated quantities are not guaranteed, and are solely for the purpose of comparison of Bids, and final payment for all Unit Price Work will be based on actual quantities, determined as provided in the Contract Documents.

ARTICLE 4—TIME OF COMPLETION

- 4.01 Bidder agrees that the Work will be substantially complete and will be completed and ready for final payment in accordance with Paragraph 15.06 of the General Conditions on or before the dates or within the number of calendar days indicated in the Agreement.
- 4.02 Bidder accepts the provisions of the Agreement as to liquidated damages.

ARTICLE 5—BIDDER’S ACKNOWLEDGEMENTS: ACCEPTANCE PERIOD, INSTRUCTIONS, AND RECEIPT OF ADDENDA

5.01 *Bid Acceptance Period*

- A. This Bid will remain subject to acceptance for 30 days after the Bid opening, or for such longer period of time that Bidder may agree to in writing upon request of Owner.

5.02 *Instructions to Bidders*

- A. Bidder accepts all of the terms and conditions of the Instructions to Bidders, including without limitation those dealing with the disposition of Bid security.

5.03 *Receipt of Addenda*

- A. Bidder hereby acknowledges receipt of the following Addenda:

Addendum Number	Addendum Date

ARTICLE 6—BIDDER’S REPRESENTATIONS AND CERTIFICATIONS

6.01 *Bidder’s Representations*

- A. In submitting this Bid, Bidder represents the following:
1. Bidder has examined and carefully studied the Bidding Documents, including Addenda.
 2. Bidder has visited the Site, conducted a thorough visual examination of the Site and adjacent areas, and become familiar with the general, local, and Site conditions that may affect cost, progress, and performance of the Work.
 3. Bidder is familiar with all Laws and Regulations that may affect cost, progress, and performance of the Work.
 4. Bidder has carefully studied the reports of explorations and tests of subsurface conditions at or adjacent to the Site and the drawings of physical conditions relating to existing surface or subsurface structures at the Site that have been identified in the Supplementary Conditions, with respect to the Technical Data in such reports and drawings.
 5. Bidder has carefully studied the reports and drawings relating to Hazardous Environmental Conditions, if any, at or adjacent to the Site that have been identified in the Supplementary Conditions, with respect to Technical Data in such reports and drawings.
 6. Bidder has considered the information known to Bidder itself; information commonly known to contractors doing business in the locality of the Site; information and observations obtained from visits to the Site; the Bidding Documents; and the Technical Data identified in the Supplementary Conditions or by definition, with respect to the effect of such information, observations, and Technical Data on (a) the cost, progress, and

performance of the Work; (b) the means, methods, techniques, sequences, and procedures of construction to be employed by Bidder, if selected as Contractor; and (c) Bidder's (Contractor's) safety precautions and programs.

7. Based on the information and observations referred to in the preceding paragraph, Bidder agrees that no further examinations, investigations, explorations, tests, studies, or data are necessary for the performance of the Work at the Contract Price, within the Contract Times, and in accordance with the other terms and conditions of the Contract.
8. Bidder is aware of the general nature of work to be performed by Owner and others at the Site that relates to the Work as indicated in the Bidding Documents.
9. Bidder has given Engineer written notice of all conflicts, errors, ambiguities, or discrepancies that Bidder has discovered in the Bidding Documents, and of discrepancies between Site conditions and the Contract Documents, and the written resolution thereof by Engineer is acceptable to Contractor.
10. The Bidding Documents are generally sufficient to indicate and convey understanding of all terms and conditions for performance and furnishing of the Work.
11. The submission of this Bid constitutes an incontrovertible representation by Bidder that without exception the Bid and all prices in the Bid are premised upon performing and furnishing the Work required by the Bidding Documents.

6.02 *Bidder's Certifications*

A. The Bidder certifies the following:

1. This Bid is genuine and not made in the interest of or on behalf of any undisclosed individual or entity and is not submitted in conformity with any collusive agreement or rules of any group, association, organization, or corporation.
2. Bidder has not directly or indirectly induced or solicited any other Bidder to submit a false or sham Bid.
3. Bidder has not solicited or induced any individual or entity to refrain from bidding.
4. Bidder has not engaged in corrupt, fraudulent, collusive, or coercive practices in competing for the Contract. For the purposes of this Paragraph 8.02.A:
 - a. Corrupt practice means the offering, giving, receiving, or soliciting of anything of value likely to influence the action of a public official in the bidding process.
 - b. Fraudulent practice means an intentional misrepresentation of facts made (a) to influence the bidding process to the detriment of Owner, (b) to establish bid prices at artificial non-competitive levels, or (c) to deprive Owner of the benefits of free and open competition.
 - c. Collusive practice means a scheme or arrangement between two or more Bidders, with or without the knowledge of Owner, a purpose of which is to establish bid prices at artificial, non-competitive levels.

COLTON GLENN AVENUE STREET/ UTILITY IMPROVEMENTS
COLTON, SOUTH DAKOTA
BID FORM

- d. Coercive practice means harming or threatening to harm, directly or indirectly, persons or their property to influence their participation in the bidding process or affect the execution of the Contract.

COLTON GLENN AVENUE STREET/ UTILITY IMPROVEMENTS
COLTON, SOUTH DAKOTA
BID FORM

BIDDER hereby submits this Bid as set forth above:

Bidder:

(typed or printed name of organization)

By:

(individual's signature)

Name:

(typed or printed)

Title:

(typed or printed)

Date:

(typed or printed)

If Bidder is a corporation, a partnership, or a joint venture, attach evidence of authority to sign.

Attest:

(individual's signature)

Name:

(typed or printed)

Title:

(typed or printed)

Date:

(typed or printed)

Address for giving notices:

Bidder's Contact:

Name:

(typed or printed)

Title:

(typed or printed)

Phone:

Email:

Address:

Bidder's Contractor License No.: (if applicable)

Base Bid					Base Bid Continued					Bid Alternate A				
ITEM NO.	SPEC SECTION	DESCRIPTION OF WORK AND MATERIALS	QTY	UNIT	ITEM NO.	SPEC SECTION	DESCRIPTION OF WORK AND MATERIALS	QTY	UNIT	ITEM NO.	SPEC SECTION	DESCRIPTION OF WORK AND MATERIALS	QTY	UNIT
1	SC-6.03	Railroad Protective Liability Insurance	1	LS	50	32 9200-4.1	Seeding	1.2	Acre	A-1	01 7113-2.1	Mobilization	1	LS
2	01 0000-5.4	Flagging	4	Hour	51	33 1000-4.2	8" Dia. PVC Watermain	1,646	LF	A-2	01 0000-5.6	Salvage & Reinstall Mailbox	2	Each
3	01 0000-5.4	Traffic Control	453	SF	52	33 1000-4.2	6" Dia. PVC Watermain	151	LF	A-3	01 0000-5.6	Temporary Mailbox	2	Each
4	01 0000-5.4	Type 3 Barricade - 6 Ft. Double-Sided	4	Each	53	33 1000-4.2	4" Dia. PVC Watermain	4	LF	A-4	31 2300-4.2	Remove Existing Bituminous Surfacing	1,117	SY
5	01 0000-5.4	Type 3 Barricade - 8 Ft. Single-Sided	15	Each	54	33 1000-4.2	6" Dia. RJ PVC Watermain	80	LF	A-5	31 2300-4.2	Remove Existing Curb and Gutter	240	LF
6	01 0000-5.4	Traffic Control, Miscellaneous	1	LS	55	33 1000-4.3	8" D.I. M.J. 45 Deg. Bend w/ Joint Restraints	2	Each	A-6	31 2300-4.2	Remove Existing Concrete Surfacing	43	SY
7	01 0000-5.6	Salvage & Reinstall Mailbox	1	Each	56	33 1000-4.3	6" D.I. M.J. 45 Deg. Bend w/ Joint Restraints	2	Each	A-7	31 2300-4.2	Remove Gate Valve & Box	1	Each
8	01 0000-5.6	Temporary Mailbox	18	Each	57	33 1000-4.3	8" D.I. M.J. 11.25 Deg. Bend w/ Joint Restraints	1	Each	A-8	31 2300-4.2	Remove Fire Hydrant	1	Each
9	01 7113-2.1	Mobilization	1	LS	58	33 1000-4.3	8" x 6" D.I. M.J. Reducer w/ Joint Restraints	2	Each	A-9	31 2300-4.3	Compaction - Moisture/Density Tests	6	Each
10	31 2300-4.2	Remove Dumping Station	1	LS	59	33 1000-4.3	8" x 4" D.I. M.J. Reducer w/ Joint Restraints	1	Each	A-10	31 2300-4.4	Sanitary Sewer Bedding Material	150	Ton
11	31 2300-4.2	Remove Tree	13	Each	60	33 1000-4.3	8" Dia. D.I. M.J. Long Body Sleeve w/ Joint Restraints	1	Each	A-11	31 2300-4.4	Watermain Bedding Material	130	Ton
12	31 2300-4.2	Remove Existing Bituminous Surfacing	7,345	SY	61	33 1000-4.3	6" Dia. D.I. M.J. Long Body Sleeve w/ Joint Restraints	5	Each	A-12	31 2300-4.6	Imported Trench Backfill Material	2,244	Ton
13	31 2300-4.2	Remove Existing Gravel Surfacing	384	SY	62	33 1000-4.3	4" Dia. D.I. M.J. Long Body Sleeve w/ Joint Restraints	1	Each	A-13	31 2400-4.3	Unclassified Excavation	250	CY
14	31 2300-4.2	Remove Existing Curb and Gutter	1,007	LF	63	33 1000-4.3	8" x 8" D.I. M.J. Tee w/ Joint Restraints	2	Each	A-14	31 2400-4.8	Imported Topsoil	40	CY
15	31 2300-4.2	Remove Existing Concrete Surfacing	106	SY	64	33 1000-4.3	8" x 6" D.I. M.J. Tee w/ Joint Restraints	6	Each	A-15	31 2400-4.10	Cement Treated Subgrade	10,250	SF
16	31 2300-4.2	Remove Storm Sewer Pipe	48	LF	65	33 1000-4.4	8" Dia. D.I. M.J. Gate Valve & Box w/ Joint Restraints	8	Each	A-16	31 2400-4.11	Portland Cement	30	Ton
17	31 2300-4.2	Remove Gate Valve & Box	5	Each	66	33 1000-4.4	6" Dia. D.I. M.J. Gate Valve & Box w/ Joint Restraints	6	Each	A-17	31 2500-4.4	Temporary Vehicle Construction Entrance	1	Each
18	31 2300-4.2	Remove Gate Valve Box	2	Each	67	33 1000-4.5	Fire Hydrant w/ Joint Restraints	3	Each	A-18	32 1123-4.1	Base Course	537	Ton
19	31 2300-4.2	Remove Fire Hydrant	4	Each	68	33 1000-4.6	Concrete for Thrust Blocks	4	CY	A-19	32 1123-4.2	Geotextile Fabric	104	SY
20	31 2300-4.2	Remove Sanitary Sewer Manhole	9	Each	69	33 1000-4.7	2" Dia. PE Water Service Pipe	42	LF	A-20	32 1216-4.1	Asphalt Concrete, Class G, Type 2	134	Ton
21	31 2300-4.3	Compaction - Moisture/Density Tests	59	Each	70	33 1000-4.7	1" Dia. PE Water Service Pipe	580	LF	A-21	32 1216-4.1	Asphalt Concrete, Class G, Type 1	134	Ton
22	31 2300-4.4	Sanitary Sewer Bedding Material	1,230	Ton	71	33 1000-4.8	2" Corporation Stop and Service Saddle	1	Each	A-22	32 1613-4.1	Concrete Curb and Gutter	204	LF
23	31 2300-4.4	Watermain Bedding Material	850	Ton	72	33 1000-4.8	1" Corporation Stop and Service Saddle	18	Each	A-23	32 1613-4.2	Concrete Valley Gutter	218	SF
24	31 2300-4.5	Pipe Foundation Material	100	Ton	73	33 1000-4.9	2" Curb Stop and Box	1	Each	A-24	32 1613-4.3	Concrete Fillet Section	141	SF
25	31 2300-4.6	Imported Trench Backfill Material	14,406	Ton	74	33 1000-4.9	1" Curb Stop and Box	18	Each	A-25	32 1613-4.4	6" Concrete Approach/Driveway Pavement	271	SF
26	31 2300-4.8	Exploratory Excavation	10	Hour	75	33 1000-4.10	24" Steel Encasement Pipe - Railroad Crossing	60	LF	A-26	32 9200-4.1	Seeding	0.1	Acre
27	31 2400-4.3	Unclassified Excavation	3,550	CY	76	33 1000-4.10	20" Steel Encasement Pipe - Railroad Crossing	45	LF	A-27	33 1000-4.2	6" Dia. PVC Watermain	336	LF
28	31 2400-4.4	Scarify and Recompact	215	CY	77	33 1000-4.11	16" PVC Encasement Pipe	20	LF	A-28	33 1000-4.3	6" D.I. M.J. 45 Deg. Bend w/ Joint Restraints	2	Each
29	31 2400-4.5	Digout Excavation	50	CY	78	33 1000-4.12	Temporary Water Service	1	LS	A-29	33 1000-4.3	6" Dia. D.I. M.J. Long Body Sleeve w/ Joint Restraints	1	Each
30	31 2400-4.7	Subbase Foundation Aggregate	100	Ton	79	33 1000-4.13	Tracer Wire	1,997	LF	A-30	33 1000-4.3	6" x 6" D.I. M.J. Tee w/ Joint Restraints	1	Each
31	31 2400-4.8	Imported Topsoil	500	CY	80	33 1000-4.14	Rigid Insulation	48	LF	A-31	33 1000-4.4	6" Dia. D.I. M.J. Gate Valve & Box w/ Joint Restraints	2	Each
32	31 2400-4.9	Strip, Stockpile, and Reinstall Topsoil	525	CY	81	33 1000-4.15	Temporary Fire Hydrant	1	Each	A-32	33 1000-4.5	Fire Hydrant w/ Joint Restraints	1	Each
33	31 2400-4.10	Cement Treated Subgrade	60,600	SF	82	33 3000-4.2	12" Dia. PVC Gravity Sewer Pipe	371	LF	A-33	33 1000-4.6	Concrete for Thrust Blocks	1	CY
34	31 2400-4.11	Portland Cement	167	Ton	83	33 3000-4.2	10" Dia. PVC Gravity Sewer Pipe	278	LF	A-34	33 1000-4.7	1" Dia. PE Water Service Pipe	95	LF
35	31 2500-4.1	Erosion Control Blanket	308	SY	84	33 3000-4.2	8" Dia. PVC Gravity Sewer Pipe	1,703	LF	A-35	33 1000-4.8	1" Corporation Stop and Service Saddle	4	Each
36	31 2500-4.2	Silt Fence	215	LF	85	33 3000-4.2	10" Dia. R.J. PVC Gravity Sewer Pipe	80	LF	A-36	33 1000-4.9	1" Curb Stop and Box	4	Each
37	31 2500-4.3	Inlet Sediment Control Device	1	Each	86	33 3000-4.2	4" Dia. PVC Gravity Sewer Pipe	663	LF	A-37	33 1000-4.13	Tracer Wire	358	LF
38	31 2500-4.4	Temporary Vehicle Construction Entrance	7	Each	87	33 3000-4.3	8" x 4" Sanitary Sewer Service Connection	20	Each	A-38	33 3000-4.2	8" Dia. PVC Gravity Sewer Pipe	316	LF
39	31 2500-4.5	Concrete Washout Area	1	Each	88	33 3000-4.3	10" x 4" Sanitary Sewer Service Connection	4	Each	A-39	33 3000-4.2	4" Dia. PVC Gravity Sewer Pipe	110	LF
40	32 1123-4.1	Base Course	3,911	Ton	89	33 3000-4.3	12" x 4" Sanitary Sewer Service Connection	2	Each	A-40	33 3000-4.3	8" x 4" Sanitary Sewer Service Connection	4	Each
41	32 1123-4.2	Geotextile Fabric	1,429	SY	90	33 3000-4.4	48" Dia. Sanitary Sewer Manhole	10	Each					
42	32 1216-4.1	Asphalt Concrete, Class G, Type 2	830	Ton	91	33 3000-4.5	Additional Vertical Manhole Feet	27	VF					
43	32 1216-4.1	Asphalt Concrete, Class G, Type 1	845	Ton	92	33 4100-4.2	48" Arch RCP Storm Sewer	48	LF					
44	32 1216-4.3	Asphalt Concrete Sampling and Testing	4	Each	93	33 4100-4.4	6' x 3' Sioux Falls Drop Inlet	1	Each					
45	32 1613-4.1	Concrete Curb and Gutter	913	LF										
46	32 1613-4.2	Concrete Valley Gutter	375	SF										
47	32 1613-4.3	Concrete Fillet Section	555	SF										
48	32 1613-4.4	6" Concrete Approach/Driveway Pavement	862	SF										
49	32 1613-4.5	Concrete Sampling and Testing	2	Each										

Bid Alternate B				
ITEM NO.	SPEC SECTION	DESCRIPTION OF WORK AND MATERIALS	QTY	UNIT
A-1	31 2300-4.2	Remove Storm Sewer Pipe	175	LF
A-2	33 4100-4.2	48" Arch RCP Storm Sewer	175	LF
A-3	33 4100-4.3	48" Arch RCP Flared End Section	1	Each



PROJECT / SHEET TITLE:		COLTON GLENN AVENUE STREET / UTILITY IMPROVEMENTS	
ESTIMATE OF QUANTITIES SHEET		COLTON, SOUTH DAKOTA	
DESCRIPTION			
REV.	DATE		



JOB No.: 23083.00.01
DATE: DECEMBER 2019
DESIGNED BY:
CHECKED BY:
DRAWN BY:

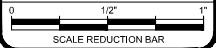

WATER SERVICES:
PROVIDE WATER SERVICES AT APPROXIMATE LOCATIONS:
STA. 14+24 - 8' RT. TO 34' LT. - 42 L.F. 1" PIPE, SADDLE & CORP., CURB STOP & BOX
STA. 14+87 - 8' RT. TO 14+90 - 20' LT. - 30 L.F. 1" PIPE, SADDLE & CORP., CURB STOP & BOX
STA. 16+01 - 8' RT. TO 32' LT. - 40 L.F. 1" PIPE, SADDLE & CORP., CURB STOP & BOX
STA. 16+66 - 8' RT. TO 24' LT. - 32 L.F. 1" PIPE, SADDLE & CORP., CURB STOP & BOX
STA. 17+84 - 8' RT. TO 34' LT. - 42 L.F. 2" PIPE, SADDLE & CORP., CURB STOP & BOX

*OTHER SERVICES MAY BE LOCATED THAT ARE NOT SHOWN ON THESE DRAWINGS.

WATERMAIN:
STA. 13+00 - 16' LT. TO 18+00 - 12' LT.
ABANDON:
500 L.F. OF WATERMAIN (INCIDENTAL)

STA. 13+00 - 9' RT. TO 18+00 - 9' RT.
FURNISH AND INSTALL:
500 L.F. - 8" DIA. PVC WATERMAIN
500 L.F. - TRACER WIRE

STA. 14+90 TO 15+10 - 9' RT.
FURNISH AND INSTALL:
20 L.F. - 16" DIA. PVC ENCASEMENT PIPE
8 L.F. - 2" RIGID INSULATION BETWEEN NEW STORM SEWER PIPE AND WATERMAIN

WATERMAIN:
STA. 15+24 - 8' RT.
FURNISH AND INSTALL:
1 EA. - 8"x6" D.I. M.J. TEE W/ JOINT RESTRAINTS
1 EA. - 8" DIA. D.I. M.J. GATE VALVE AND BOX W/ JOINT RESTRAINTS
1 EA. - 6" DIA. D.I. M.J. GATE VALVE AND BOX W/ JOINT RESTRAINTS
CONCRETE THRUST BLOCKS
REF: 2ND STREET SHEET I-7 FOR CONTINUATION OF 6" WATERMAIN (E)

WATERMAIN:
STA. 15+44 - 32' LT.
REMOVE:
1 EA. - FIRE HYDRANT

WATERMAIN:
STA. 16+81 - 9' RT.
FURNISH AND INSTALL:
1 EA. - 8" D.I. M.J. 11.25 DEG. BEND W/ JOINT RESTRAINTS

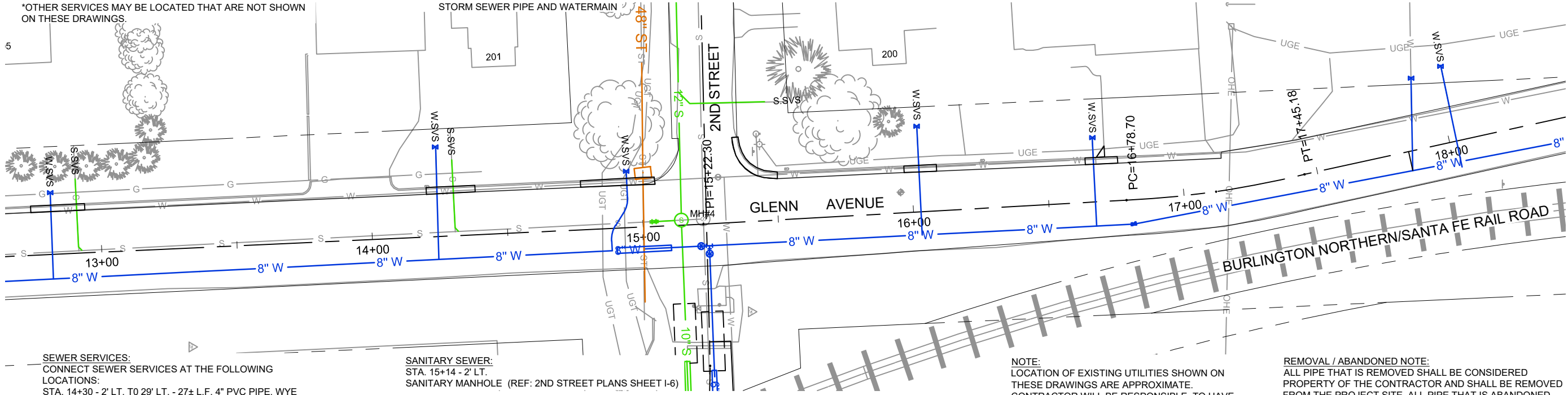
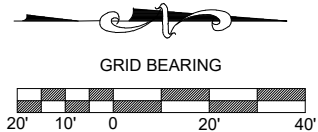

SEWER SERVICES:
CONNECT SEWER SERVICES AT THE FOLLOWING LOCATIONS:
STA. 14+30 - 2' LT. TO 29' LT. - 27± L.F. 4" PVC PIPE, WYE

*OTHER SERVICES MAY BE LOCATED THAT ARE NOT SHOWN ON THESE DRAWINGS. ALL CONNECTIONS REQUIRE FERNCO TO CONNECT TO EXISTING (INCIDENTAL)

SANITARY SEWER:
STA. 15+14 - 2' LT.
SANITARY MANHOLE (REF: 2ND STREET PLANS SHEET I-6)

SANITARY SEWER:
STA. 15+22 - 1' LT.
EXISTING SANITARY MANHOLE (REF: 2ND STREET PLANS SHEET I-6)

NOTE:
LOCATION OF EXISTING UTILITIES SHOWN ON THESE DRAWINGS ARE APPROXIMATE. CONTRACTOR WILL BE RESPONSIBLE TO HAVE ALL UTILITIES AND SERVICES LOCATED PRIOR TO ANY EXCAVATION.

REMOVAL / ABANDONED NOTE:
ALL PIPE THAT IS REMOVED SHALL BE CONSIDERED PROPERTY OF THE CONTRACTOR AND SHALL BE REMOVED FROM THE PROJECT SITE. ALL PIPE THAT IS ABANDONED SHALL HAVE ENDS PLUGGED WITH CONCRETE OR CAPPED. NOTE: NOT ALL CAP LOCATIONS HAVE BEEN IDENTIFIED. ADDITIONAL CAPS MAY BE REQUIRED.

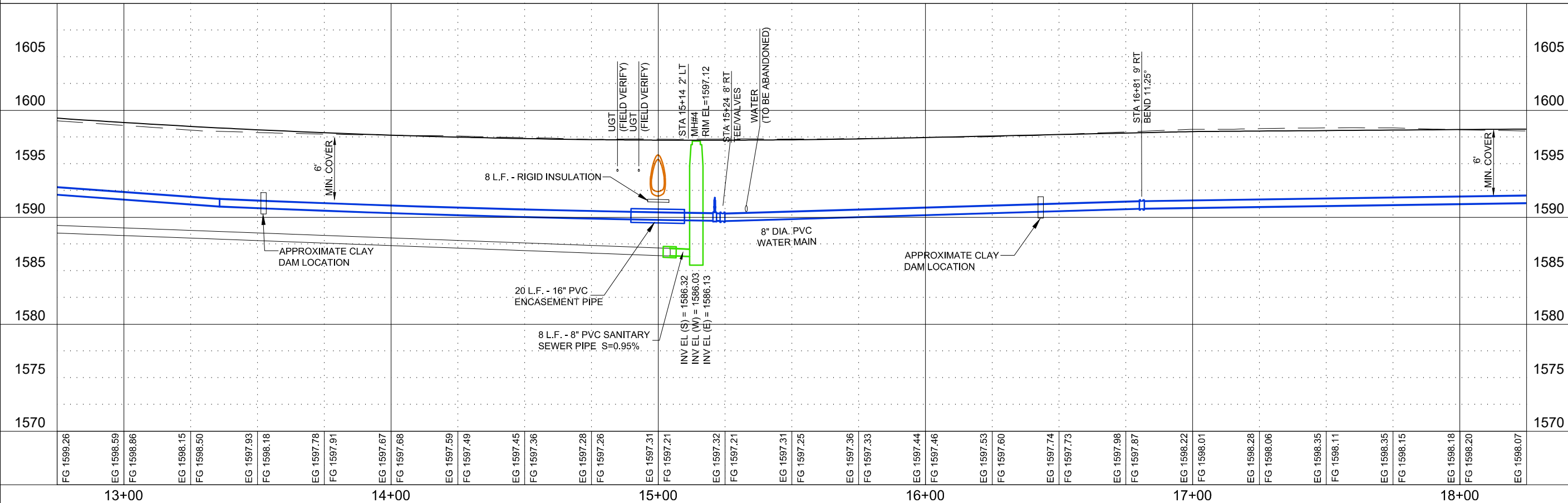

PROJECT / SHEET TITLE:
COLTON GLENN AVENUE STREET / UTILITY IMPROVEMENTS

GLENN AVENUE WATER & SANITARY SEWER - STA. 13+00 TO 18+00

DESCRIPTION

COLTON, SOUTH DAKOTA



JOB No.: 23083.00.01
DATE: DECEMBER 2019
DESIGNED BY: WJB
CHECKED BY: PJC
DRAWN BY: CMC

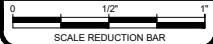

SHEET No.:

I-3